

ARCHITECT ANTE VRBAN

Historic location dating from 1821.
Today gets redefined to a new era of elegance and luxury.

Welcome to
16 Custom Architect Ante Vrban residential interiors

for

BUSINESS RESIDENTIAL BUILDING ROVINJ

ARCHITECT ANTE VRBAN

for

S-I-2 APARTMENT

Total 136,48 m²

Parking 25,22 m²

APARTMENT S-I-2

+ PM 2

136,48 m² + 25,22 m²

- 1st floor



STAN S-I-2 - 1.KAT					
BR.	OPIS PROSTORIJE	PODNA OBLOGA	KOEF.	PODNA POVRŠINA	NETTO POVRŠINA
1	HODNIK 1	parket	1,00	5.69 m ²	5.69 m ²
2	WC	pločice	1,00	1.95 m ²	1.95 m ²
3	DNEVNI BORAVAK I BLAGOVAONICA	parket	1,00	39.52 m ²	39.52 m ²
4	KUHINJA	parket	1,00	10.80 m ²	10.80 m ²
5	SPREMA	pločice	1,00	1.80 m ²	1.80 m ²
6	HODNIK 2	parket	1,00	3.14 m ²	3.14 m ²
7	SPAVAČA SOBA 1	parket	1,00	12.08 m ²	12.08 m ²
8	SPAVAČA SOBA 2	parket	1,00	11.79 m ²	11.79 m ²
9	KUPAONICA 1	pločice	1,00	4.86 m ²	4.86 m ²
10	SPAVAČA SOBA 3	parket	1,00	15.86 m ²	15.86 m ²
11	GARDEROBA	parket	1,00	6.53 m ²	6.53 m ²
12	KUPAONICA 2	pločice	1,00	8.32 m ²	8.32 m ²
13	LOGGIA	decking	0,75	18.87 m ²	14.15 m ²
STAN S-I-2 - 1.KAT				141,19 m ²	136,48 m ²
STAN S-I-2 - PM 2					25,22 m ²









ARCHITECT ANTE VRBAN



ARCHITECT ANTE VRBAN



ARCHITECT ANTE VRBAN



ARCHITECT ANTE VRBAN



ARCHITECT ANTE VRBAN



ARCHITECT ANTE VRBAN



ARCHITECT ANTE VRBAN



ARCHITECT ANTE VRBAN



ARCHITECT ANTE VRBAN

GARAGE - PARKING SPACE (PM)

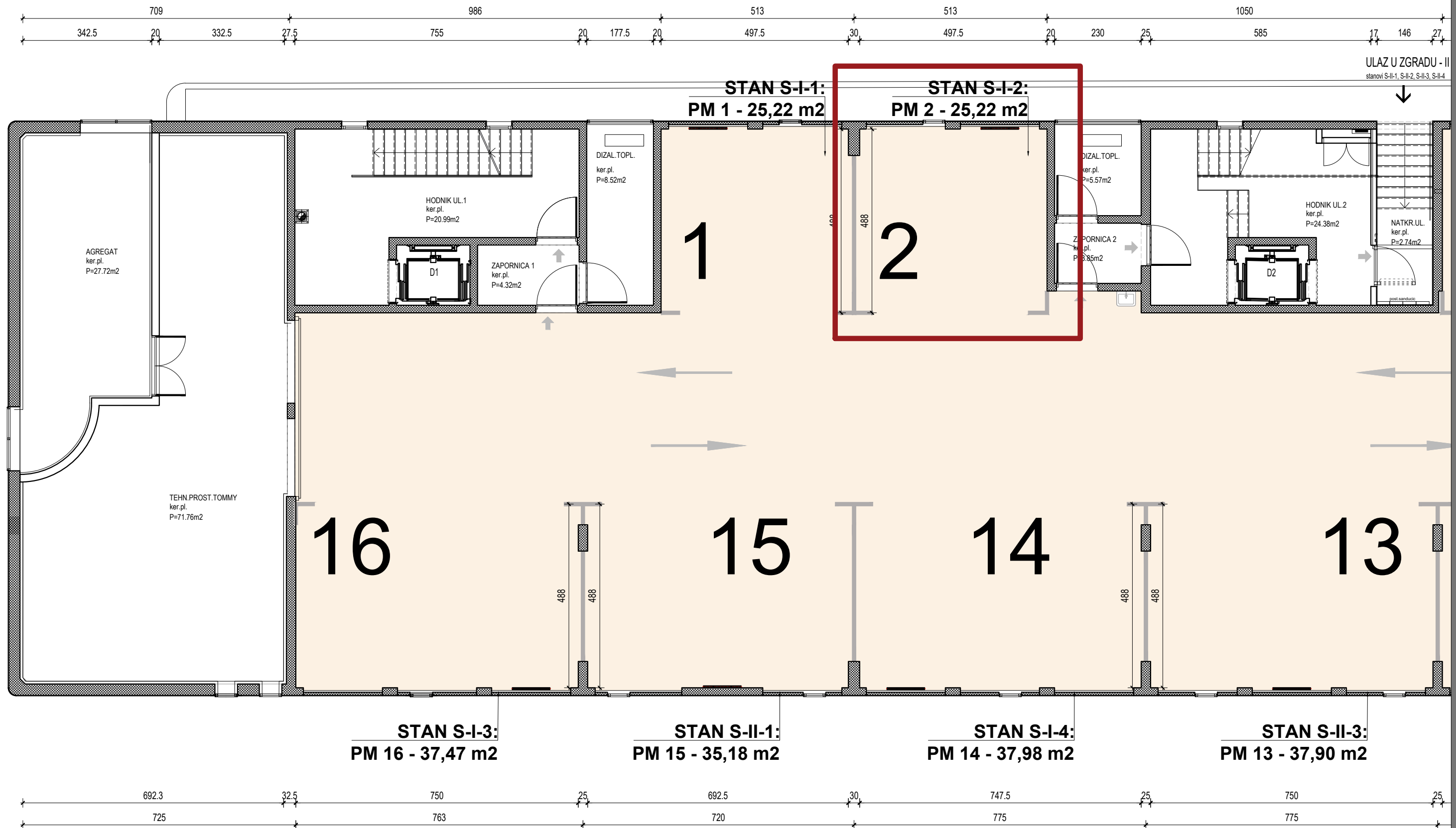





PM 3

PM 4



ARCHITECT ANTE VRBAN

16 Custom Architect Ante Vrban residential interiors

for

BUSINESS RESIDENTIAL BUILDING ROVINJ